

THE JERIVALE



BUILDING MADE PERSONAL.



-Craftsman Style-

FEATURES:

- Open Layout with Focal Staircase
- Vaulted Ceilings and Coffered Ceilings Throughout Home
- Large Master Suite with His and Her Closet
 - Master Sitting Area, Fireplace, and Private Patio
- Formal Family Room with Fireplace
- Formal Dining, Study, and Breakfast Rooms
 - Large Utility Room
- Large Kitchen with Double Island

THE JERIVALE



MAIN FLOOR: 2766 FT²

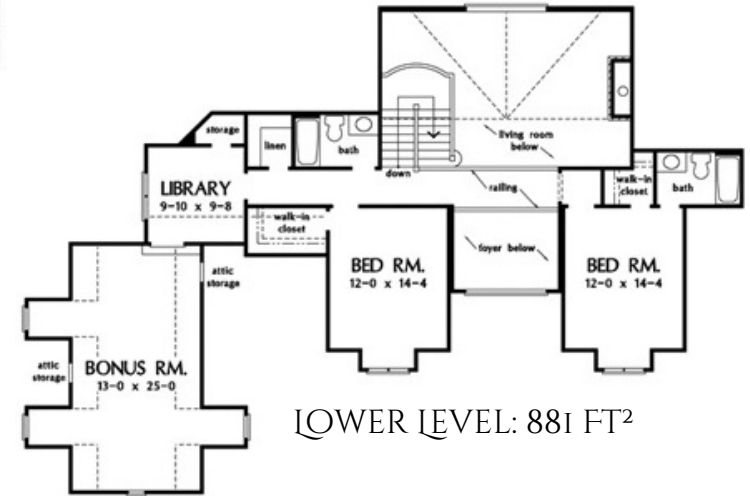

LOWER LEVEL: 881 FT²

BED	3
BATH	3.5
FINISHED SQ FT	3647 FT. ²
WIDTH	92'
DEPTH	72'

